

Main Dimensions

		SAMPLER CAPACITY(liters)							
		1,7	2,5	5	8	10	12	20	30
A	inch	25.0	33.0	27.2	35.0	41.0	46	35.0	46.0
	mm	633	8	692	889	1041	1168	889	1168
B	inch	13	13	13	13	13	13	13	13
	mm	330	330	330	330	330	330	330	330
C	inch	2.5	2.5	3.5	3.5	3.5	3.5	3.5	3.5
	mm	63	63	63	63	63	63	63	63
D	inch	3.5	3.5	5.6	5.6	5.6	5.6	8.6	8.6
	mm	89.0	89.0	142.0	142.0	142.0	142.0	218.0	218.0
E	inch	5.5	5.5	7.6	7.6	7.6	7.6	10.7	10.7
	mm	139	139	192	192	192	192	273	273
F	inch	8.0	8.0	10.1	10.1	10.1	10.1	13.3	13.3
	mm	204	204	257	257	257	257	338	338
G	inch	18.0	26.0	20.0	28.0	34.0	39.0	24.3	37.0
	mm	457	660	508	711	863	990	711	990
EMPTY WEIGHT	lb	5.5	6.5	8.0	10.0	12.5	13.5	25.0	28.0
	kg	2.5	3.0	3.6	4.5	5.7	6.1	11.4	12.7
FULL WEIGHT	lb	9.2	12.1	19.0	27.6	34.5	39.9	69.0	94.1
	kg	4.20	5.50	8.63	12.54	15.68	18.13	31.35	42.71
END OPENING	inch	2.9						5.0	
	mm	74						127	

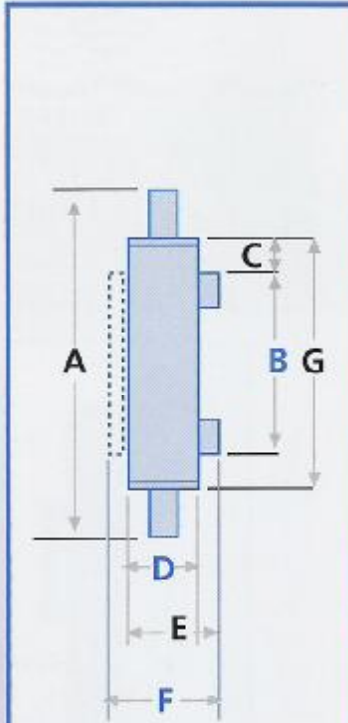

Reversing thermometer assembly model 112 RTA

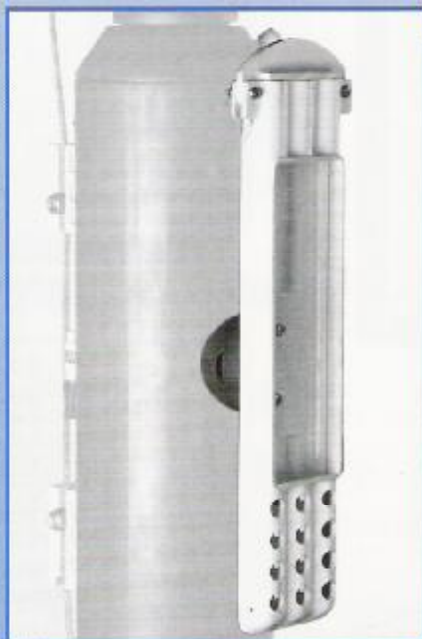

A non-metallic, high impact ABS plastic thermometer rack is attached to a pivotal PVC mounting block.

The mounting block is permanently fixed on the sampler body. The rack which can hold three (3) reversing thermometers is easily removable and interchangeable. Sampler capacity must be specified for the intended reversing assembly. Thermometer reversing assembly which can hold up to three (3) reversing thermometer and can be factory installed on new orders or easily added on existing samplers.

112 RTA on 5.0 liter sampler

